

Submersible Agitators SE



ATEX version available
for range 11-22 kW



SAVECO[®]
A WAMGROUP[®] Brand

HIGHLY EFFICIENT, RELIABLE AND EASY TO INSTALL

CHIOR® SE Submersible Agitators are applied for mixing livestock effluents in open tanks as well as fermentation residues in anaerobic digesters.

The particular shape of the stainless-steel propeller guarantees high mixing efficiency even with effluents with a high solids content.

Each agitator model is modular with different propeller shapes and sizes to maximise the ratio between performance and energy consumption.

Equipped with an adjustable stainless steel bracket, CHIOR® SE Submersible Agitators enable quick installation on a vertical pipe.

Technical Data

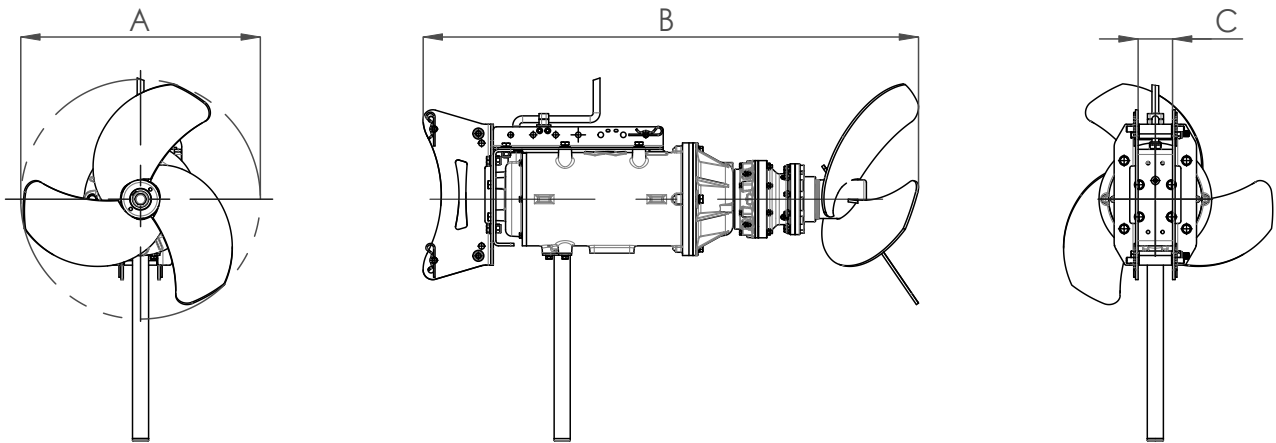

MODEL	Drive Power (kW)	RPM	Weight (kg)	Dimensions (mm)		
				A	B	C
SE-022	2.2	250	120	510	1,005	80 - 100
SE-030	3.0	250	140	560	1,025	80 - 100
SE-040	4.0	250	150	570	1,045	80 - 100
SE-055	5.5	250	165	645	1,275	80 - 100
SE-075	7.5	250	170	710	1,295	80 - 100
SE-110-LE	11.0	140	320	1,000	1,685	100 - 120
SE-150-LE	15.0	140	330	1,100	1,765	100 - 120
SE-110-ST	11.0	280	300	650	1,485	100 - 120
SE-150-ST	15.0	280	320	740	1,545	100 - 120
SE-185-ST	18.5	280	330	770	1,555	100 - 120
SE-220-ST	22.0	280	340	800	1,570	100 - 120
SE-110-VE	11.0	355	290	530	1,440	100 - 120
SE-150-VE	15.0	355	305	590	1,465	100 - 120
SE-185-VE	18.5	355	315	610	1,485	100 - 120
SE-220-VE	22.0	355	325	710	1,505	100 - 120

Benefits

- ✓ High efficiency with very low energy consumption thanks to modern, innovative propeller design
- ✓ Wide power spectrum according to speed selection, drive power and propeller diameter
- ✓ Engineered 3-blade propeller with high mixing effect

- ✓ Easy maintenance thanks to modular design

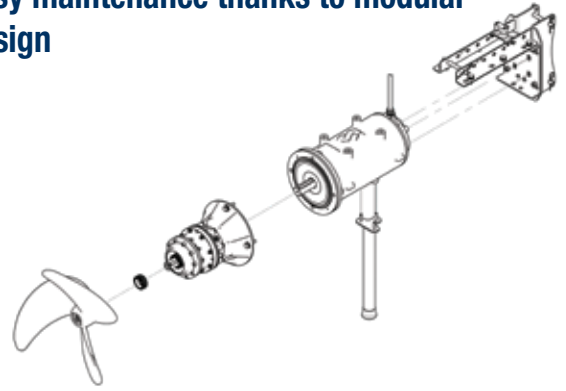

Technical Features

- Cast iron body
- Submersible IE3 motor (Premium Efficiency)
- 3-phase, 4-pole, insulation class F electric motor
- IP68 motor protection
- Thermal probe to prevent overheating of electric motor
- Cemented carbide mechanical seals
- Self-lubricating radial roller bearings
- NBR O-ring seals
- EM7 rubber-sheathed cable with stainless-steel cable gland
- Adjustable 304 SS support frame suitable for various pole sizes
- Stainless-steel limit switch foot



ATEX version available
for range 11-22 kW



Engineered 304 SS
three-blade propeller



Innovative support bracket
improving the sliding of the
most robust agitators
(available for
SE range 11-22 kW)

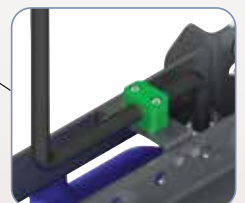

Electrical cable with
strain relief system



Planetary gears in oil-bath

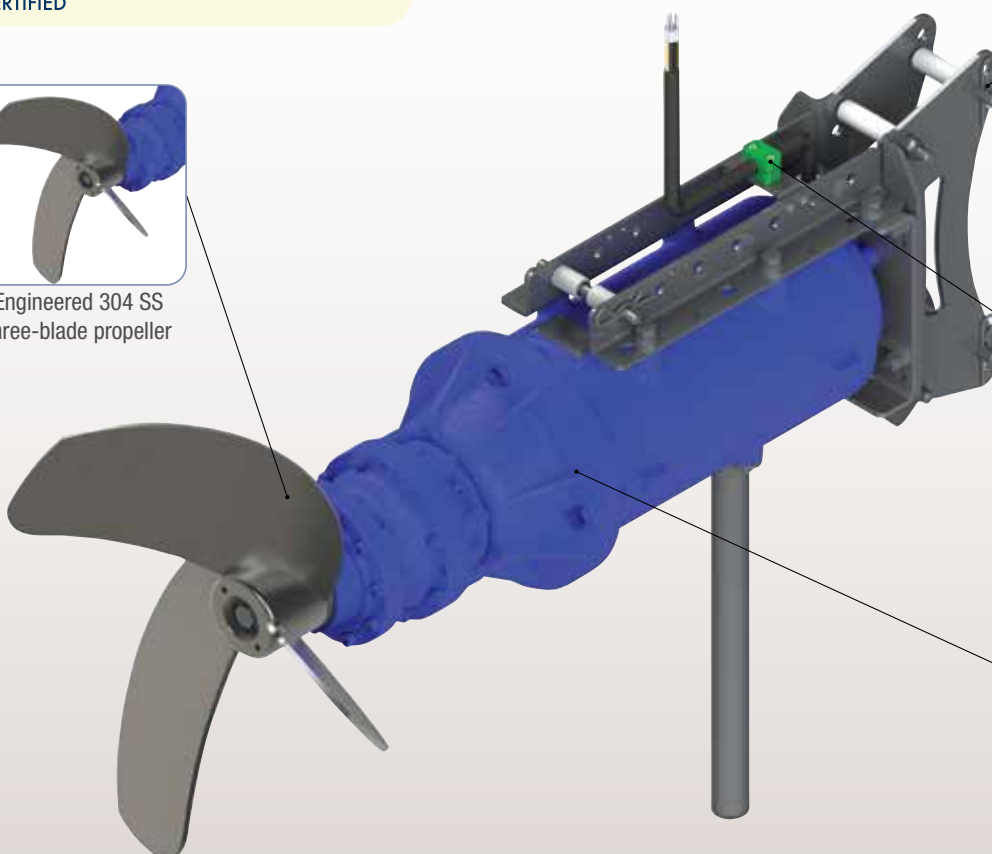

Product Range Performance

SE Range 2.2 - 7.5 kW

MODEL	RPM	Mixing results*:		Suitable for
		Thrust up to (N)	Flow rate up to (m ³ / h)	
SE 022 - SE 040	250	900	2,650	livestock sector
SE 055 - SE 075	250	1,650	4,300	livestock and biogas

SE Range 11 - 22 kW

MODEL	RPM	Mixing results*:		Suitable for
		Thrust up to (N)	Flow rate up to (m ³ / h)	
SE Lento (LE)	140	6,000	16,000	primary processing of large volumes
SE Standard (ST)	280	5,800	12,000	multiple applications
SE Veloce (VE)	355	5,600	10,000	crushing of surface crust

* Values measured with clear water at 20° C.

Results may vary by changing the operating conditions depending on density, viscosity and dry matter content. The information and illustrations are not binding.



203001716 June 2022 Rights reserved to modify technical specifications.

This brochure has been edited for distribution in European Union countries

